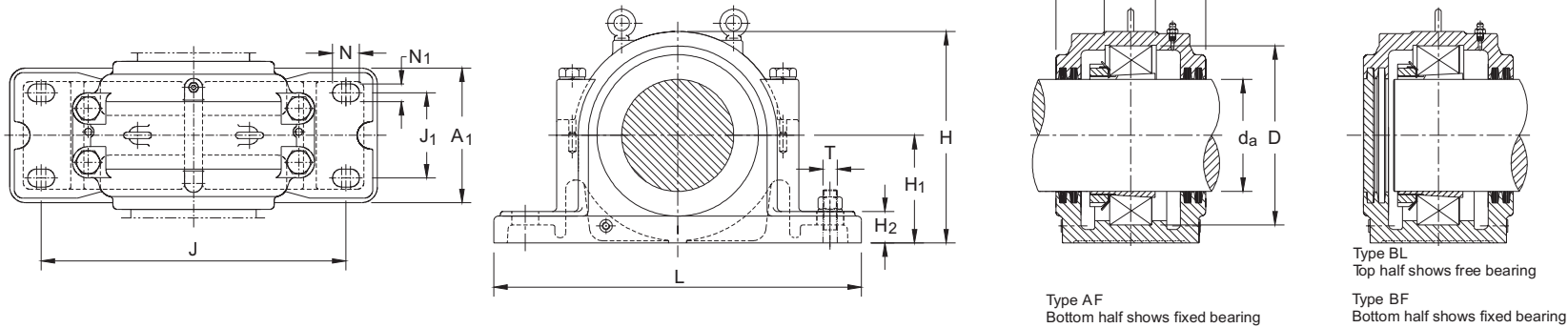



TABLE - 19

**SD 30 Series plummer blocks for spherical roller bearings with adapter sleeves Shaft dia 150 to 360 mm.**



Shaft Dia. $d_a$	Designation of Housing	D	L	$A_1$	$H_2$	$C_a$	$H_1$	$A_2$	H	J	$J_1$	$N_1$	N	T	Approx Weight kg.	Appropriate Bearing	Adapter Sleeves	Lacating Ring designation	Qty.
150	<b>SD 3034</b>	260	540	200	50	77	160	230	320	450	110	36	52	M 30	62	23034 CCK/W33	H 3034	FRB 10/260	1
160	<b>SD 3036</b>	280	560	220	50	84	170	250	340	470	120	36	52	M 30	78	23036 CCK/W33	H 3036	FRB 10/280	1
170	<b>SD 3038</b>	290	560	220	50	85	170	250	345	470	120	36	52	M 30	82	23038 CCK/W33	H 3038	FRB 10/290	1
180	<b>SD 3040</b>	310	620	230	60	92	180	270	360	510	140	36	52	M 30	92	23040 CCK/W33	H 3040	FRB 10/310	1
200	<b>SD 3044</b>	340	700	260	65	100	200	290	400	570	160	36	55	M 30	125	23044 CCK/W33	H 3044	FRB 10/340	1
220	<b>SD 3048</b>	360	740	260	65	102	210	300	420	610	170	36	55	M 30	140	23048 CCK/W33	H 3048	FRB 10/360	1
240	<b>SD 3052</b>	400	820	300	70	114	240	330	475	680	190	43	62	M 36	200	23052 CCK/W33	H 3052	FRB 10/400	1
260	<b>SD 3056</b>	420	860	320	85	116	250	350	500	710	200	43	62	M 36	230	23056 CCK/W33	H 3056	FRB 10/420	1
280	<b>SD 3060</b>	460	920	330	85	128	280	360	550	770	210	43	62	M 36	290	23060 CCK/W33	H 3060	FRB 10/460	1
300	<b>SD 3064</b>	480	940	340	85	131	280	370	560	790	210	43	62	M 36	300	23064 CCK/W33	H 3064	FRB 10/480	1
320	<b>SD 3068</b>	520	1020	370	100	143	310	400	615	860	230	50	70	M 42	400	23068 CCK/W33	H 3068	FRB 10/520	1
340	<b>SD 3072</b>	540	1060	390	100	144	325	410	640	890	250	50	70	M 42	450	23072 CCK/W33	H 3072	FRB 10/540	1
360	<b>SD 3076</b>	560	1080	390	100	145	340	410	665	900	260	50	70	M 42	470	23076 CCK/W33	H 3076	FRB 10/560	1