

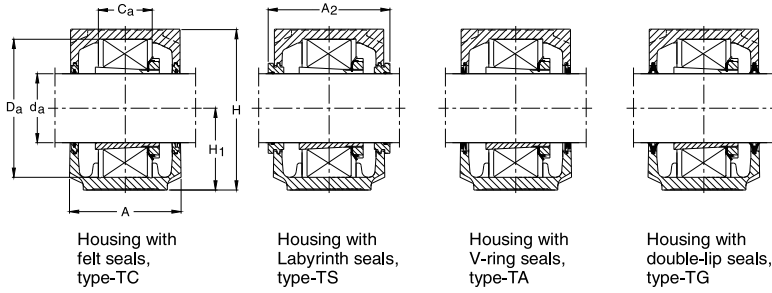

**SNH 500 & 600 plummer block housings
for bearings with ADAPTER SLEEVE
Shaft dia 20 to 140 mm**

TABLE - 13



Material	C.I. FG 260 - IS 210, 1993
Mfg. Standard	IS 14347 - 1996 ISO 113 - 1994
Seal	TC (Felt), Optional : TA or TS
Lubrication	Grease or Oil
Type	Horizontal Split Type
Application	Suitable moderate to heavy load with continuous operation having hostile surrounding and temperature. Versatile design allows facilities for oil circulation, drain, temperature & Vibration measurement, etc.
Options Available	a) 4 Foundation Bolt Hole Base b) V-seal (TA), Double Lip seal (TG), Labyrinth seal (TS) c) End cover for closed end type d) Tapped Hole for Drain & Temp. measuring. e) Solid base for heavy load application. f) Oil Inlet for forced oil feed circulation. g) Material : Cast steel, S.G.Iron.

Shaft diameter d_a	Housing Dimensions													Approx Weight	Designation with		
	A	A_1	A_2	C_a	D_a	H	H_1	H_2	J	L	N	N_1	T		felt seal	labyrinth seal	Double-lip seal
mm	mm													kg			
20	67	46	80	25	52	74	40	19	130	165	20	15	12	1,50	SNH 505 TC	SNH 505 TS	SNH 505 TG
	77	52	89	32	62	89	50	22	150	185	20	15	12	2,00	SNH 605 TC	SNH 605 TS	SNH 605 TG
25	77	52	89	32	62	89	50	22	150	185	20	15	12	2,00	SNH 506 TC	SNH 506 TS	SNH 506 TG
	82	52	94	34	72	93	50	22	150	185	20	15	12	2,20	SNH 606 TC	SNH 606 TS	SNH 606 TG
30	82	52	94	34	72	93	50	22	150	185	20	15	12	2,20	SNH 507 TC	SNH 507 TS	SNH 507 TG
	85	60	97	39	80	107	60	25	170	205	20	15	12	3,00	SNH 607 TC	SNH 607 TS	SNH 607 TG
35	85	60	97	39	80	107	60	25	170	205	20	15	12	3,00	SNH 508 TC	SNH 508 TS	SNH 508 TG
	90	60	102	41	90	113	60	25	170	205	20	15	12	3,30	SNH 608 TC	SNH 608 TS	SNH 608 TG
40	85	60	97	30	85	109	60	25	170	205	20	15	12	3,00	SNH 509 TC	SNH 509 TS	SNH 509 TG
	95	70	107	44	100	127	70	28	210	255	24	18	16	4,50	SNH 609 TC	SNH 609 TS	SNH 609 TG

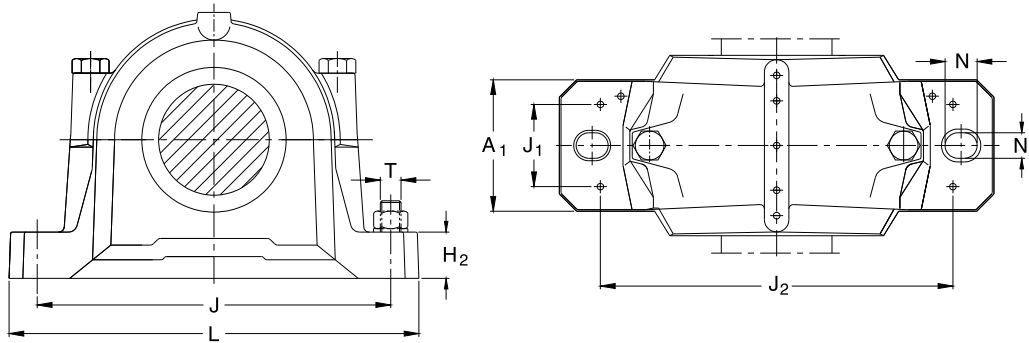

V-ring seals	Appropriate bearing	adapter sleeve	locating ring No. and designation	Separate Components		
				Felt seals designation	Labyrinth seal designation	End cover designation
—	—	—	—	—	—	—
SNH 505 TA	1205 EK 2205 EK 22205 EK	H 205 H 305 H 305	2 FRB 5/52 2 FRB 3,5/52 2 FRB 3,5/52	TSNA 505 C	TSNA 505 S	ASNH 505
SNH 605 TA	1305 EK 2305 K	H 305 H 2305	2 FRB 7,5/62 2 FRB 4/62	TSNA 605 C	TSNA 605 S	ASNH 506-605
SNH 506 TA	1206 EK 2206 EK 22206 EK	H 206 H 306 H 306	2 FRB 8/62 2 FRB 6/62 2 FRB 6/62	TSNA 506 C	TSNA 506 S	ASNH 506-605
SNH 606 TA	1306 EK 2306 K	H 306 H 2306	2 FRB 7,5/72 2 FRB 3,5/72	TSNA 606 C	TSNA 606 S	ASNH 507-606
SNH 507 TA	1207 EK 2207 EK 22207 CCK	H 207 H 307 H 307	2 FRB 8,5/72 2 FRB 5,5/72 2 FRB 5,5/72	TSNA 507 C	TSNA 507 S	ASNH 507-606
SNH 607 TA	1307 EK 2307 EK	H 307 H 2307	2 FRB 9/80 2 FRB 4/80	TSNA 607 C	TSNA 607 S	ASNH 508-607
SNH 508 TA	1208 EK 2208 EK 22208 EK	H 208 H 308 H 308	2 FRB 10,5/80 2 FRB 8/80 2 FRB 8/80	TSNA 508 C	TSNA 508 S	ASNH 508-607
SNH 608 TA	1308 EK 2308 EK 21308 CCK 22308 CCK	H 308 H 2308 H 308 H 2308	2 FRB 9/90 2 FRB 4/90 2 FRB 9/90 2 FRB 4/90	TSNA 608 C	TSNA 608 S	ASNH 510-608
SNH 509 TA	1209 EK 2209 EK 22209 EK	H 209 H 309 H 309	2 FRB 5,5/85 2 FRB 3,5/85 2 FRB 3,5/85	TSNA 509 C	TSNA 509 S	ASNH 509
SNH 609 TA	1309 EK 2309 EK 21309 CCK 22309 CCK	H 309 H 2309 H 309 H 2309	2 FRB 9,5/100 2 FRB 4/100 2 FRB 9,5/100 2 FRB 4/100	TSNA 609 C	TSNA 609 S	ASNH 511-609



**SNH 500 & 600 plummer block housings
for bearings with ADAPTER SLEEVE
Shaft dia 20 to 140 mm**

TABLE - 13

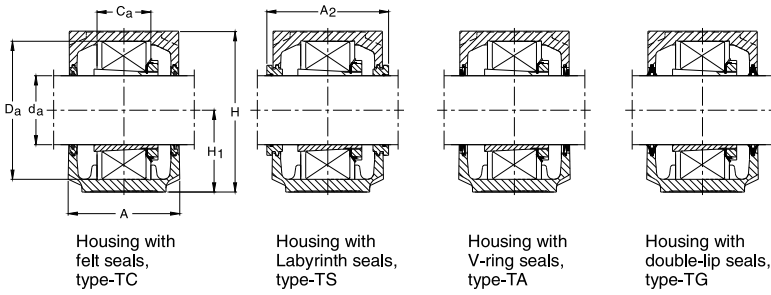

Material	C.I. FG 260 - IS 210, 1993
Mfg. Standard	IS 14347 - 1996 ISO 113 - 1994
Seal	TC (Felt), Optional : TA or TS
Lubrication	Grease or Oil
Type	Horizontal Split Type
Application	Suitable moderate to heavy load with continuous operation having hostile surrounding and temperature. Versatile design allows facilities for oil circulation, drain, temperature & Vibration measurement, etc.
Options Available	a) 4 Foundation Bolt Hole Base b) V-seal (TA), Double Lip seal (TG), Labyrinth seal (TS) c) End cover for closed end type d) Tapped Hole for Drain & Temp. measuring. e) Solid base for heavy load application. f) Oil Inlet for forced oil feed circulation. g) Material : Cast steel, S.G.Iron.

Shaft diameter d_a	Housing Dimensions													Approx Weight	Designation with		
	A	A_1	A_2	C_a	D_a	H	H_1	H_2	J	L	N	N_1	T		felt seal	labyrinth seal	Double-lip seal
mm	mm													kg			
45	90	60	102	41	90	113	60	25	170	205	20	15	12	3,30	SNH 510 TC	SNH 510 TS	SNH 510 TG
	105	70	117	48	110	133	70	30	210	255	24	18	16	5,00	SNH 610 TC	SNH 610 TS	SNH 610 TG
50	95	70	107	44	100	127	70	28	210	255	24	18	16	4,50	SNH 511 TC	SNH 511 TS	SNH 511 TG
	110	80	122	51	120	148	80	30	230	275	24	18	16	6,50	SNH 611 TC	SNH 611 TS	SNH 611 TG
55	105	70	117	48	110	133	70	30	210	255	24	18	16	5,00	SNH 512 TC	SNH 512 TS	SNH 512 TG
	115	80	127	56	130	154	80	30	230	280	24	18	16	7,20	SNH 612 TC	SNH 612 TS	SNH 612 TG
60	110	80	122	51	120	148	80	30	230	275	24	18	16	6,50	SNH 513 TC	SNH 513 TS	SNH 513 TG
	120	90	138	58	140	175	95	32	260	315	28	22	20	9,50	SNH 613 TC	SNH 613 TS	SNH 613 TG

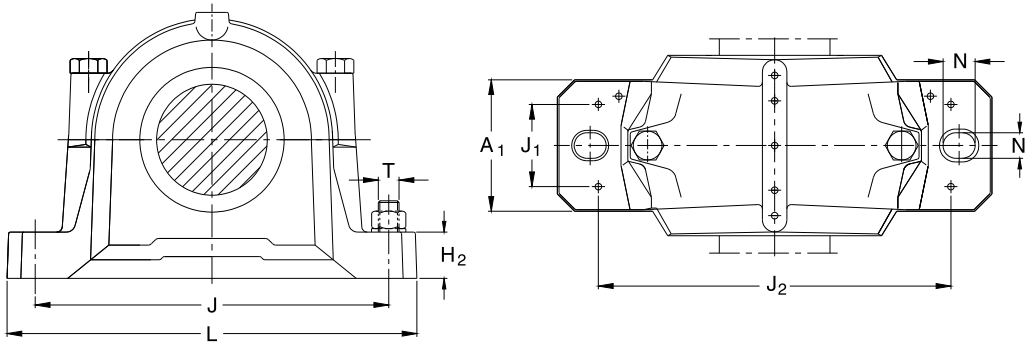

V-ring seals	Appropriate bearing	adapter sleeve	locating ring No. and designation	Separate Components		
				Felt seals designation	Labyrinth seal designation	End cover designation
—	—	—	—	—	—	—
SNH 510 TA	1210 EK 2210 EK 22210 CCK	H 210 H 310 H 310	2 FRB 10,5/90 2 FRB 9/90 2 FRB 9/90	TSNA 510 C	TSNA 510 S	ASNH 510-608
SNH 610 TA	1310 EK 2310 K 21310 CCK 22310 CCK	H 310 H 2310 H 310 H 2310	2 FRB 10,5/110 2 FRB 4/110 2 FRB 10,5/110 2 FRB 4/110	TSNA 610 C	TSNA 610 S	ASNH 512-610
SNH 511 TA	1211 EK 2211 EK 22211 EK	H 211 H 311 H 311	2 FRB 11,5/100 2 FRB 9,5/100 2 FRB 9,5/100	TSNA 511 C	TSNA 511 S	ASNH 511-609
SNH 611 TA	1311 EK 2311 K 21311 CCK 22311 EK	H 311 H 2311 H 311 H 2311	2 FRB 11/120 2 FRB 4/120 2 FRB 11/120 2 FRB 4/120	TSNA 611 C	TSNA 611 S	ASNH 513-611
SNH 512 TA	1212 EK 2212 EK 22212 EK	H 212 H 312 H 312	2 FRB 13/110 2 FRB 10/110 2 FRB 10/110	TSNA 512 C	TSNA 512 S	ASNH 512-610
SNH 612 TA	1312 K 2312 K 21312 CCK 22312 EK	H 312 H 2312 H 312 H 2312	2 FRB 12,5/130 2 FRB 5/130 2 FRB 12,5/130 2 FRB 5/130	TSNA 612 C	TSNA 612 S	ASNH 515-612
SNH 513 TA	1213 EK 2213 EK 22213 CCK	H 213 H 313 H 313	2 FRB 14/120 2 FRB 10/120 2 FRB 10/120	TSNA 513 C	TSNA 513 S	ASNH 513-611
SNH 613 TA	1313 EK 2313 K 21313 CCK 22313 EK	H 313 H 2313 H 313 H 2313	2 FRB 12,5/140 2 FRB 5/140 2 FRB 12,5/140 2 FRB 5/140	TSNA 613 C	TSNA 613 S	ASNH 516-613



TABLE - 13

**SNH 500 & 600 plummer block housings for bearings with ADAPTER SLEEVE
Shaft dia 20 to 140 mm**

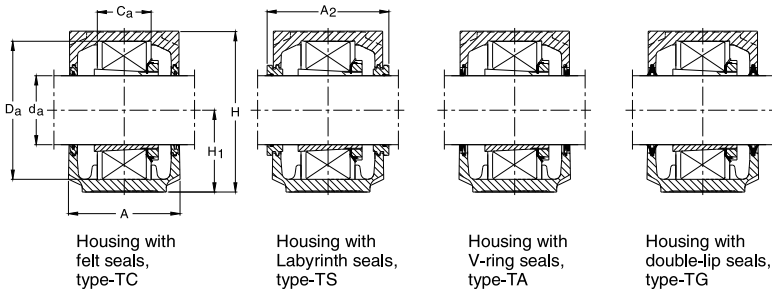

Material	C.I. FG 260 - IS 210, 1993
Mfg. Standard	IS 14347 - 1996 ISO 113 - 1994
Seal	TC (Felt), Optional : TA or TS
Lubrication	Grease or Oil
Type	Horizontal Split Type
Application	Suitable moderate to heavy load with continuous operation having hostile surrounding and temperature. Versatile design allows facilities for oil circulation, drain, temperature & Vibration measurement, etc.
Options Available	a) 4 Foundation Bolt Hole Base b) V-seal (TA), Double Lip seal (TG), Labyrinth seal (TS) c) End cover for closed end type d) Tapped Hole for Drain & Temp. measuring. e) Solid base for heavy load application. f) Oil Inlet for forced oil feed circulation. g) Material : Cast steel, S.G.Iron.

Shaft diameter d_a	Housing Dimensions													Approx Weight	Designation with		
	A	A ₁	A ₂	C _a	D _a	H	H ₁	H ₂	J	L	N	N ₁	T		felt seal	labyrinth seal	Double-lip seal
mm	mm													kg			
65	115	80	127	56	130	154	80	30	230	280	24	18	16	7,20	SNH 515 TC	SNH 515 TS	SNH 515 TG
	140	100	158	65	160	193	100	35	290	345	28	22	20	12,7	SNH 615 TC	SNH 615 TS	SNH 615 TG
70	120	90	138	58	140	175	95	32	260	315	28	22	20	9,50	SNH 516 TC	SNH 516 TS	SNH 516 TG
	145	100	163	68	170	210	112	35	290	345	28	22	20	13,90	SNH 616 TC	SNH 616 TS	SNH 616 TG
75	125	90	143	61	150	183	95	32	260	320	28	22	20	10,0	SNH 517 TC	SNH 517 TS	SNH 517 TG
	160	110	178	70	180	215	112	40	320	380	32	26	24	17,6	SNH 617 TC	SNH 617 TS	SNH 617 TG
80	140	100	158	65	160	193	100	35	290	345	28	22	20	12,7	SNH 518 TC	SNH 518 TS	SNH 518 TG
85	145	100	163	68	170	210	112	35	290	345	28	22	20	13,90	SNH 519 TC	SNH 519 TS	SNH 519 TG
	175	120	191	80	200	239	125	45	350	410	32	26	24	22,00	SNH 619 TC	SNH 619 TS	SNH 619 TG

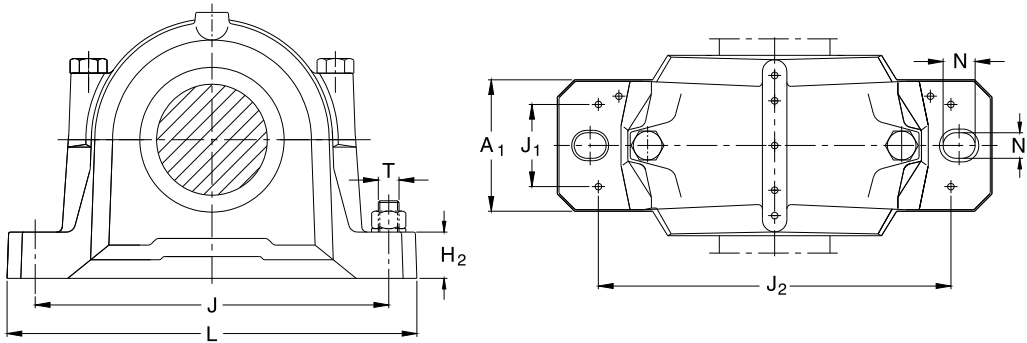

V-ring seals	Appropriate bearing	adapter sleeve	locating ring No. and designation	Separate Components		
				Felt seals designation	Labyrinth seal designation	End cover designation
—	—	—	—	—	—	—
SNH 515 TA	1215 K 2215 K 22215 EK	H 215 H 315 H 315	2 FRB 15,5/130 2 FRB 12,5/130 2 FRB 12,5/130	TSNA 515 C	TSNA 515 S	ASNH 515-612
SNH 615 TA	1315 K 2315 K 21315 CCK 22315 EK	H 315 H 2315 H 315 H 2315	2 FRB 14/160 2 FRB 5/160 2 FRB 14/160 2 FRB 5/160	TSNA 615 C	TSNA 615 S	ASNH 518-615
SNH 516 TA	1216 K 2216 EK 22216 EK	H 216 H 316 H 316	2 FRB 16/140 2 FRB 12,5/140 2 FRB 12,5/140	TSNA 516 C	TSNA 516 S	ASNH 516-613
SNH 616 TA	1316 K 2316 K 21316 CCK 22316 EK	H 316 H 2316 H 316 H 2316	2 FRB 14,5/170 2 FRB 5/170 2 FRB 14,5/170 2 FRB 5/170	TSNA 616 C	TSNA 616 S	ASNH 519-616
SNH 517 TA	1217 K 2217 K 22217 EK	H 217 H 317 H 317	2 FRB 16,5/150 2 FRB 12,5/150 2 FRB 12,5/150	TSNA 517 C	TSNA 517 S	ASNH 517
SNH 617 TA	1317 K 2317 K 21317 CCK 22317 EK	H 317 H 2317 H 317 H 2317	2 FRB 14,5/180 2 FRB 5/180 2 FRB 14,5/180 2 FRB 5/180	TSNA 617 C	TSNA 617 S	ASNH 520-617
SNH 518 TA	1218 K 2218 K 22218 EK 23218 CCK/W33	H 218 H 318 H 318 H 2318	2 FRB 17,5/160 2 FRB 12,5/160 2 FRB 12,5/160 2 FRB 6,25/160	TSNA 518 C	TSNA 518 S	ASNH 518-615
SNH 519 TA	1219 K 2219 K 22219 EK	H 219 H 319 H 319	2 FRB 18/170 2 FRB 12,5/170 2 FRB 12,5/170	TSNA 519 C	TSNA 519 S	ASNH 519-616
SNH 619 TA	1319 K 2319 K 21319 CCK 22319 EK	H 319 H 2319 H 319 H 2319	2 FRB 17,5/200 2 FRB 6,5/200 2 FRB 17,5/200 2 FRB 6,5/200	TSNA 619 C	TSNA 619 S	ASNH 522-619



TABLE - 13

**SNH 500 & 600 plummer block housings
for bearings with ADAPTER SLEEVE
Shaft dia 20 to 140 mm**

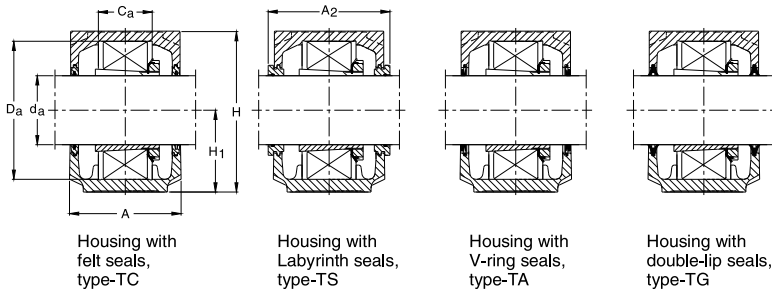

Material	C.I. FG 260 - IS 210, 1993
Mfg. Standard	IS 14347 - 1996 ISO 113 - 1994
Seal	TC (Felt), Optional : TA or TS
Lubrication	Grease or Oil
Type	Horizontal Split Type
Application	Suitable moderate to heavy load with continuous operation having hostile surrounding and temperature. Versatile design allows facilities for oil circulation, drain, temperature & Vibration measurement, etc.
Options Available	a) 4 Foundation Bolt Hole Base b) V-seal (TA), Double Lip seal (TG), Labyrinth seal (TS) c) End cover for closed end type d) Tapped Hole for Drain & Temp. measuring. e) Solid base for heavy load application. f) Oil Inlet for forced oil feed circulation. g) Material : Cast steel, S.G.Iron.

Shaft diameter d_a	Housing Dimensions													Approx Weight	Designation with		
	A	A ₁	A ₂	C _a	D _a	H	H ₁	H ₂	J	L	N	N ₁	T		felt seal	labyrinth seal	Double-lip seal
mm	mm													kg			
90	160	110	178	70	180	215	112	40	320	380	32	26	24	17,6	SNH 520 TC	SNH 520 TS	SNH 520 TG
	185	120	199	86	215	271	140	45	350	410	32	26	24	26,5	SNH 620 TC	SNH 620 TS	SNH 620 TG
100	175	120	191	80	200	239	125	45	350	410	32	26	24	22,0	SNH 522 TC	SNH 522 TS	SNH 522 TG
110	185	120	199	86	215	271	140	45	350	410	32	26	24	26,5	SNH 524 TC	SNH 524 TS	SNH 524 TG
115	190	130	208	90	230	290	150	50	380	445	35	28	24	33,0	SNH 526 TC	SNH 526 TS	SNH 526 TG
125	205	150	223	98	250	302	150	50	420	500	42	35	30	40,0	SNH 528 TC	SNH 528 TS	SNH 528 TG
135	220	160	241	106	270	323	160	60	450	530	42	35	30	49,0	SNH 530 TC	SNH 530 TS	SNH 530 TG
140	235	160	254	114	290	344	170	60	470	550	42	35	30	55,0	SNH 532 TC	SNH 532 TS	SNH 532 TG

Note: 1. Housing is supplied with 1/8" BSP grease nipple fitted on top.
 2. Housing is supplied as non-located type. For locating type order suitable locating ring ('FRB') separately.
 3. Lifting Eye Bolts are provided on housing from SNH 524 & SNH 620 onwards.

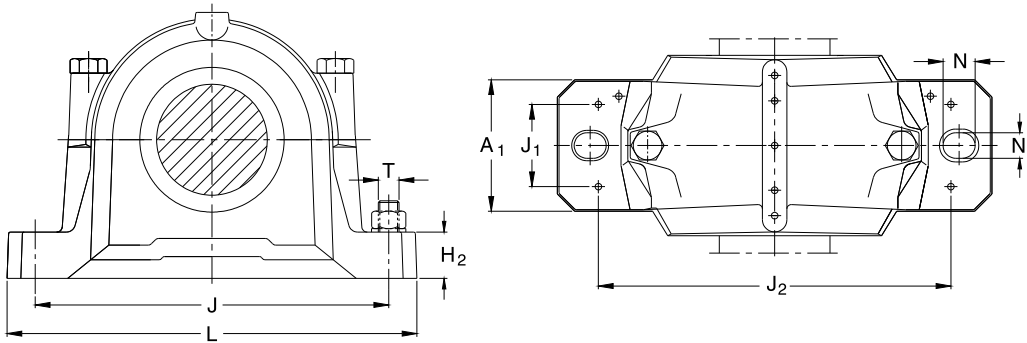

V-ring seals	Appropriate bearing	adapter sleeve	locating ring No. and designation	Separate Components		
				Felt seals designation	Labyrinth seal designation	End cover designation
—	—	—	—	—	—	—
SNH 520 TA	1220 K 2220 K 22220 EK 23220 CCK/W33	H 220 H 320 H 320 H 2320	2 FRB 18/180 2 FRB 12/180 2 FRB 12/180 2 FRB 4,85/180	TSNA 520 C	TSNA 520 S	ASNH 520-617
SNH 620 TA	1320 K 2320 K 21320 CCK 22320 EK	H 320 H 2320 H 320 H 2320	2 FRB 19,5/215 2 FRB 6,5/215 2 FRB 19,5/215 2 FRB 6,5/215	TSNA 620 C	TSNA 620 S	ASNH 524-620
SNH 522 TA	1222 K 2222 K 22222 EK 23222 CCK/W33	H 222 H 322 H 322 H 2322	2 FRB 21/200 2 FRB 13,5/200 2 FRB 13,5/200 2 FRB 5,1/200	TSNA 522 C	TSNA 522 S	ASNH 522-619
SNH 524 TA	1224 K 22224 EK 23224 CCK/W33	H 3124 H 3124 H 2324	2 FRB 22/215 2 FRB 14/215 2 FRB 5/215	TSNA 524 C	TSNA 524 S	ASNH 524-620
SNH 526 TA	22226 EK 23226 CCK/W33	H 3126 H 2326	2 FRB 13/230 2 FRB 5/230	TSNA 526 C	TSNA 526 S	ASNH 526
SNH 528 TA	22228 CCK/W33 23228 CCK/W33	H 3128 H 2328	2 FRB 15/250 2 FRB 5/250	TSNA 528 C	TSNA 528 S	ASNH 528
SNH 530 TA	22230 CCK/W33 23230 CCK/W33	H 3130 H 2330	2 FRB 16,5/270 2 FRB 5/270	TSNA 530 C	TSNA 530 S	ASNH 530
SNH 532 TA	22232 CCK/W33 23232 CCK/W33	H 3132 H 2332	2 FRB 17/290 2 FRB 5/290	TSNA 532 C	TSNA 532 S	ASNH 532

4. Refer Table III and V for selecting alternative material and seal in case of higher load conditions.
5. Our SN, SNA & SNH type housings are designed inter-changeable for same bearing size and mounting dimensions.
6. For higher load application solid base housings are available on request.